

**Verge gutter profile / Roof Extension Profile: Principles of design**

- Site-formed apex sections are not permissible although site bending is permissible (subject to manufacturer's recommendations) – secondary lead/lead replacement flashing is required over site bent fabrications
- Verge Unions to overlap Apex and Verge gutter profile by 40mm
- Mechanically fixed to wall to resist wind uplift
- Integrated system (backed by thermal insulation as required)
- Water-tight connections with silicone sealant and waterproof membrane to provide primary and secondary seals.
- Joints in verge profile to be offset by min. 100mm from joints in membrane.
- Double sealed between render abutment and membrane under verge profile
- Lead replacement flashing securely fixed as per manufacturers recommendations into masonry or below cement pointing.

**RCS Detail 10**

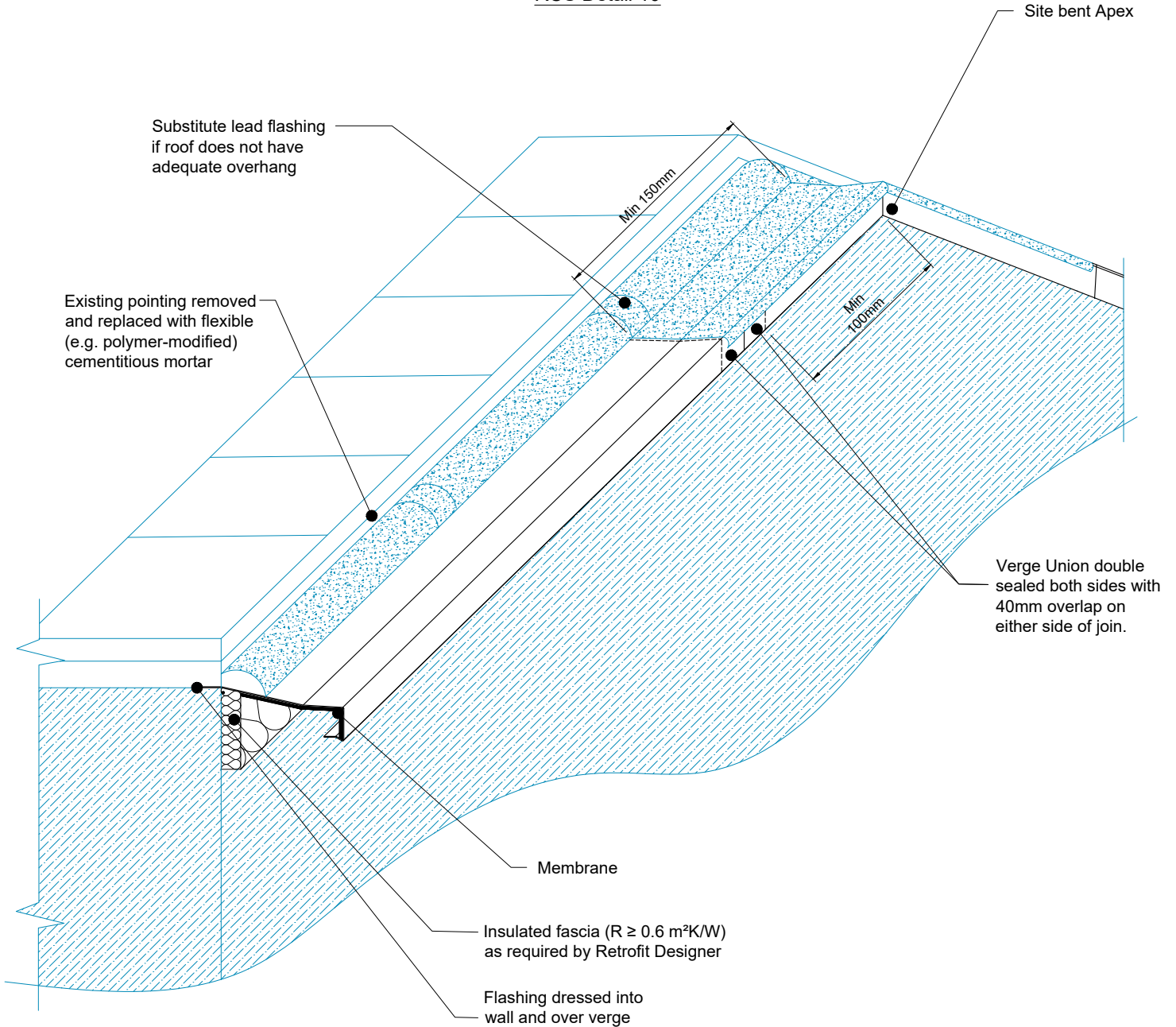

Benx Ltd, Lonsdale Chambers,  
 Lonsdale Street,  
 Stoke-on-Trent  
 Staffordshire  
 ST4 4BT  
 Telephone: 0845 130 0983  
 Email:  
[technicalservices@benx.co.uk](mailto:technicalservices@benx.co.uk)

REV	DATE	NOTE	BY
A	13/06/24	First issue	AG

STATUS:	INFORMATION
PROJECT:	PAS 2035 - RCS Detail 10
ISO No:	5225_EPS
DRAWING No:	TD-WS1-PAS-M-EPS-R-019
DESCRIPTION:	Verge apex verge gutter profile - site formed apex

DRAWN:	AG
CHECK:	JT
DATE:	Jun 24
REV:	A

All performance data & systems specifications are for systems constructed with materials & components as shown. The inclusion or substitution of any other manufactures materials or components invalidates both test data, system performance and compliance with CDM 2015. The information is provided and based upon details received, which are assumed to include all the relevant facts and data. While it is believed to be correct, we accept no liability for its accuracy, adequacy or completeness. Recipients must satisfy themselves as to its suitability as we do not accept responsibility for any claims or consequential loss. Acceptance of the content and subsequent design responsibility rests entirely with the recipients. Any subsequent design changes that affect the detail which we are not informed of in a written format will void this detail. None of the content may be copied without the prior approval from the Benx Group Technical Services Department. This statement should be read in conjunction with the standard terms and conditions of Benx Group.