

- Formed corner to be insulated and installed before gutter section.
- Verge unions to overlap by 40mm
- Mechanically fixed behind gutter section
- Available with insulation to help reduce the thermal transition.
- Water-tight connections with silicone sealant and waterproof membrane to provide primary and secondary seals. Joints in verge profile to be offset by min. 100mm from joints in membrane.
- Double sealed between render abutment and membrane under verge profile
- Corner section with end cap only abuts the insulation and is sealed in place with clip on overlapping render clip, this prevents cold spots and water ingress.

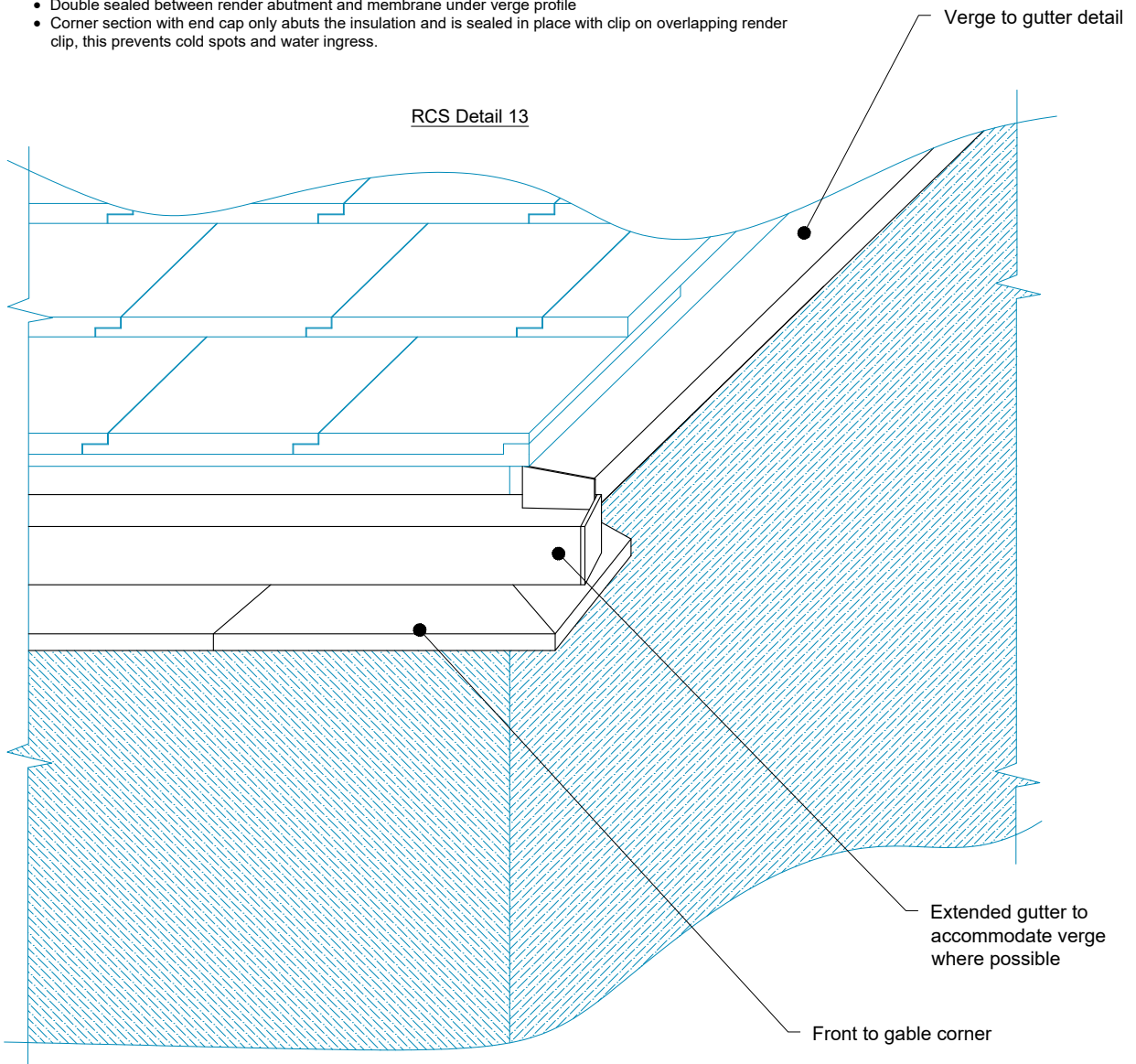

Benx Ltd, Lonsdale Chambers,
Lonsdale Street,
Stoke-on-Trent
Staffordshire
ST4 4BT
Telephone: 0845 130 0983
Email:
technicalservices@benx.co.uk

REV	DATE	NOTE	BY	STATUS:	INFORMATION	DRAWN:
A	13/06/24	First issue	AG	PROJECT: PAS 2035 - RCS Detail 13	ISO No: 5225_EPS	AG
				DRAWING No:	TD-WS1-PAS-M-EPS-R-019	CHECK: JT
				DESCRIPTION:	Front elevation eaves to gutter connection	NTS@A4
						DATE: Jun 24
						REV: A